

**Mason Business Park
Phase 1**

**3810 & 3820 Mason Road
Katy, TX 77449**

**Retail and Office Warehouse Spaces For Lease
1,167sqft – 11,900sqft Spaces
\$1.35 psfm - \$1.95 psfm**



New Business Park Development
Situating in established a well-developed area located ¼ mile from Grand Parkway on
Mason Road and Bridgewater Village Drive.

Mason Business Park Phase 1

**3810 & 3820 Mason Road
Katy, TX 77449**

3820 Mason Road Building A



A1	1,167sqft.	\$1.95 psfm. NNN
A2	1,167sqft.	\$1.95 psfm. NNN
A3	1,167sqft.	\$1.95 psfm. NNN
A4	2,100sqft.	\$1.35 psfm. NNN
A5	2,100sqft.	\$1.35 psfm. NNN
A6	2,100sqft.	\$1.35 psfm. NNN
A7	2,100sqft.	\$1.35 psfm. NNN

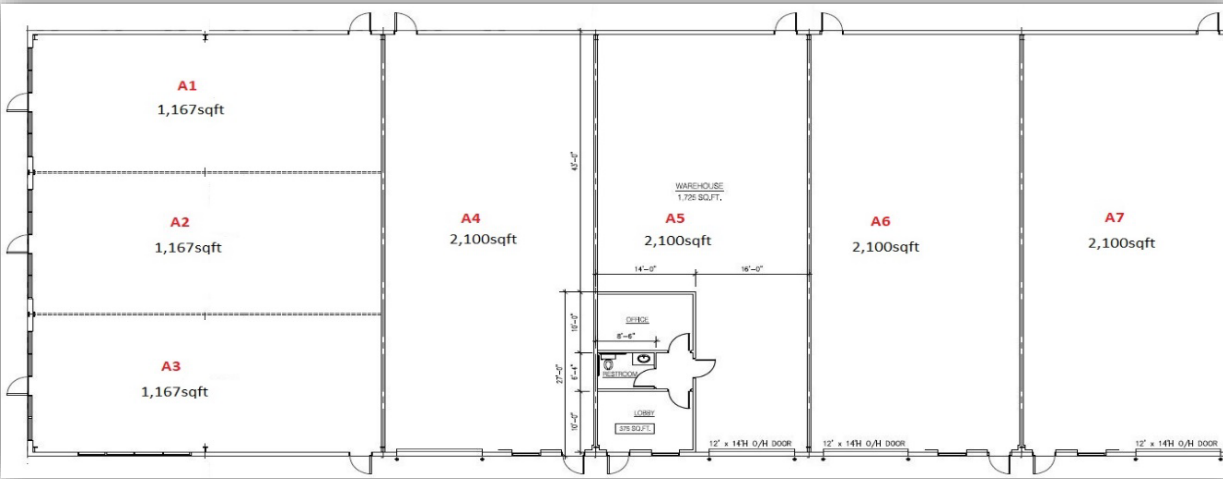

- Retail and Office Warehouse Spaces
- 1,167sqft. – 11,900sqft.
- 22' Eave Height
- 3 Phase Power
- 12x14 Grade Level Doors
- Office BTS
- ¼ mile from Grand Parkway
- Intersection of Mason Road & Bridgewater Village Drive

Mason Business Park Phase 1

3810 & 3820 Mason Road
Katy, TX 77449

3810 Mason Road Building B

B1	1,400sqft.	\$1.95 psfm. NNN
B2	1,400sqft.	\$1.95 psfm. NNN
B3	1,400sqft.	\$1.95 psfm. NNN
B4	1,925sqft.	\$1.35 psfm. NNN
B5	1,925sqft.	\$1.35 psfm. NNN
B6	1,925sqft.	\$1.35 psfm. NNN
B7	1,925sqft.	\$1.35 psfm. NNN



- Retail and Office Warehouse Spaces
- 1,400sqft. – 11,900sqft.
- 22' Eave Height
- 3 Phase Power
- 12x14 Grade Level Doors
- Office BTS
- ¼ mile from Grand Parkway
- Intersection of Mason Road & Bridgewater Village Drive

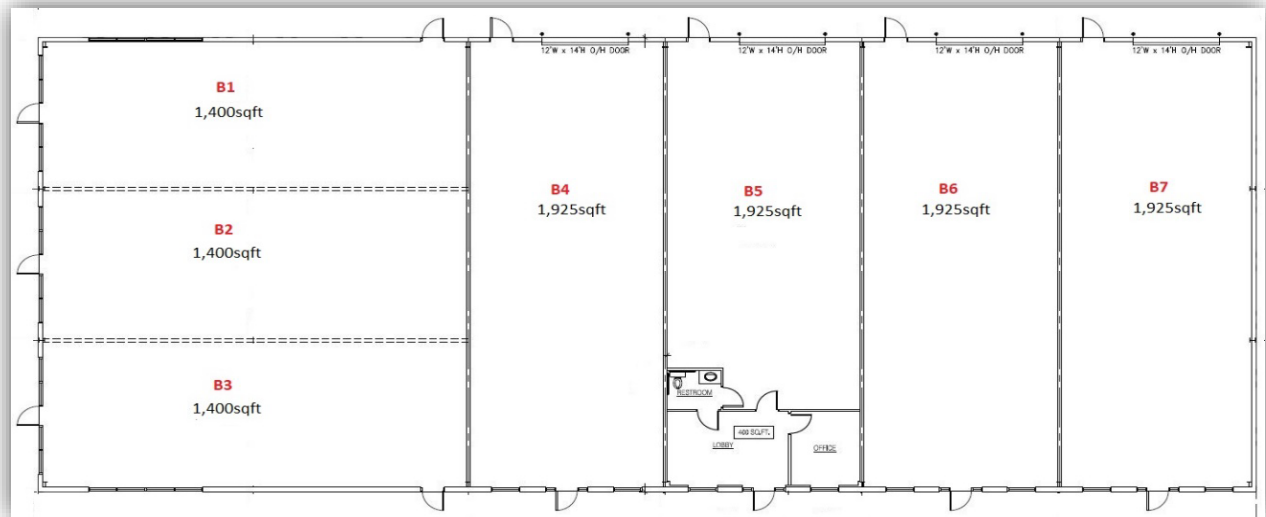

Mason Business Park
Phase 1

3810 & 3820 Mason Road
Katy, TX 77449



Brand new business park conveniently located at the intersection of Mason Road and Bridgewater Village Drive in Katy, TX. This Park offers tremendous opportunity to establish your business in a well-developed area with strong customer and employee base. Being only $\frac{1}{4}$ mile off Grand Parkway this business park allows for quick access to a major thoroughfare with little to no traffic getting to and from the property.

**Mason Business Park
Phase 1**

**3810 & 3820 Mason Road
Katy, TX 77449**

**Located less than ¼ mile from Grand
Parkway, North Mason Business Park offers
flexible options to meet your unique
business needs.**

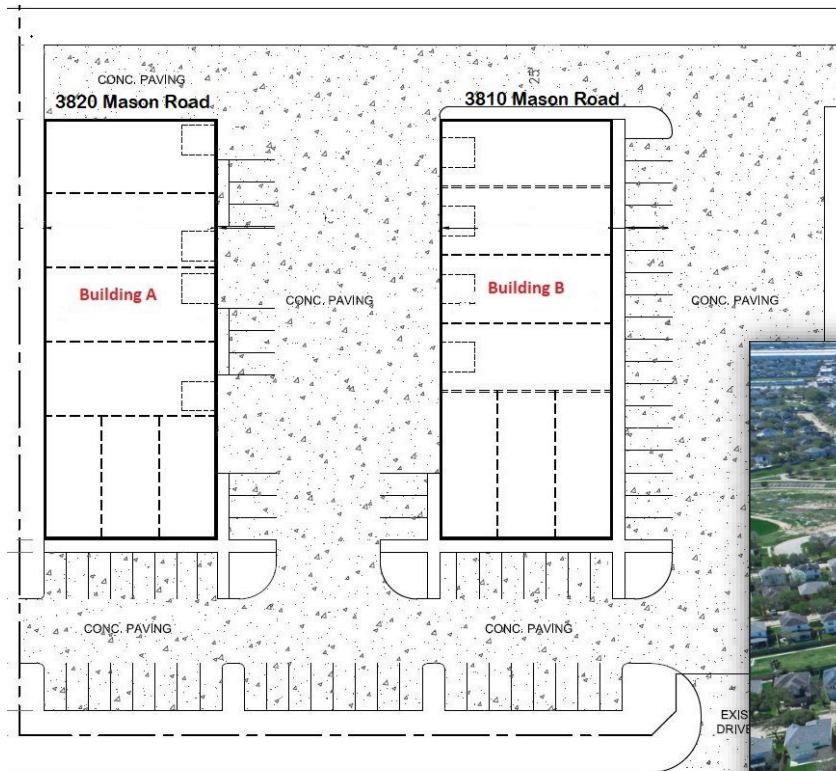

MASON ROAD

